

November 4, 2015

MEMORANDUM

TO: State Board of Regents  
FROM: David L. Buhler  
SUBJECT: Utah Valley University – Lease to Wasatch School District

Issue

Utah Valley University (UVU) wishes to inform the Board of a lease arrangement with the Wasatch School District for 8,145 square feet of space in the UVU Wasatch campus in Heber City, Utah.

Background

UVU intends to allow the Wasatch School District to lease space at the Wasatch campus for an Advanced Professional Studies center to provide high school students with career exploration opportunities. The center would be part of the Utah Cluster Acceleration Partnership, which develops and enhances educational programs needed for Utah industry and enhances career pathway programs to connect high school students with higher education. UVU will provide the space for a nominal lease of \$1 and the school district will build out the shelled space and participate in operation and maintenance (O&M) costs. UVU will also be able to utilize the space in the evening hours for university classes.

As the proposed lease will not involve operation or ownership of the property, as the construction involved will be limited to interior finishes, and as the lessee will be a public entity, it was determined from the provisions of Regent policy 712, *Nontraditional Arrangements for Development of Facilities on Campuses*, that Board approval is not necessary for this item. This item is included for Board information.

Additional details may be found in the attached letter from the University and a floor plan of the proposed lease space. Representatives from the University will be present at the meeting to respond to questions from the Board if needed.

Commissioner's Recommendation

This is an informational item and no action is needed.

---

David L Buhler  
Commissioner of Higher Education

DLB/GLS/RPA  
Attachments



UTAH VALLEY UNIVERSITY

VICE PRESIDENT *for* FINANCE & ADMINISTRATION

October 27, 2015

Commissioner David Buhler  
Utah System of Higher Education  
The Gateway  
Salt Lake City, Utah 84101

Dear Commissioner Buhler,

Utah Valley University is requesting approval to lease space to the Wasatch School District for the Center for Advanced Professional Studies in return for the build out of shell space on the Wasatch Campus.

Wasatch School Districted has requested use of the space for the Center for Advanced Professional Studies. This program would be supported by five main entities Wasatch School District, Department of Workforce Services, Heber Valley Chamber of Commerce, Wasatch Community Foundation and Utah Valley University. This program would be designed to provide high school students with the opportunity to participate in career exploration and employment workshops. The program would also consist of direct business connections. The program would align high school students with businesses who would provide students with internships to develop hands on experience.

This space is 8,145 square feet on the first floor of the Wasatch Campus Building. The lease would be for \$1 per year in consideration for the \$366,525 which would be needed to build out the space. Wasatch School District would participate in O&M costs at \$12,675.65 annually.

Utah Valley University will utilize the space in the evening hours for additional university classes. The building is lacks enough evening time class space and this will help provide more opportunities for offerings on the Wasatch Campus.

If you have any questions please feel free to contact me with any questions.

Sincerely,

Val L. Peterson  
Vice President  
Utah Valley University

VP/sk  
Enclosure



**'C.A.P.S.' FLOOR PLAN**

**COLOR LEGEND**

- ADMINISTRATION
- ▤ AGRICULTURAL ENVIRONMENTAL
- ▤ BUSINESS MARKETING
- COMMONS
- DIGITAL DESIGN
- ENGINEERING ROBOTICS
- EXISTING
- HEALTH CARE
- ▤ INNOVATION LAB / INCUBATOR SPACE
- SMALL GROUP
- SOFTWARE DEVELOPMENT

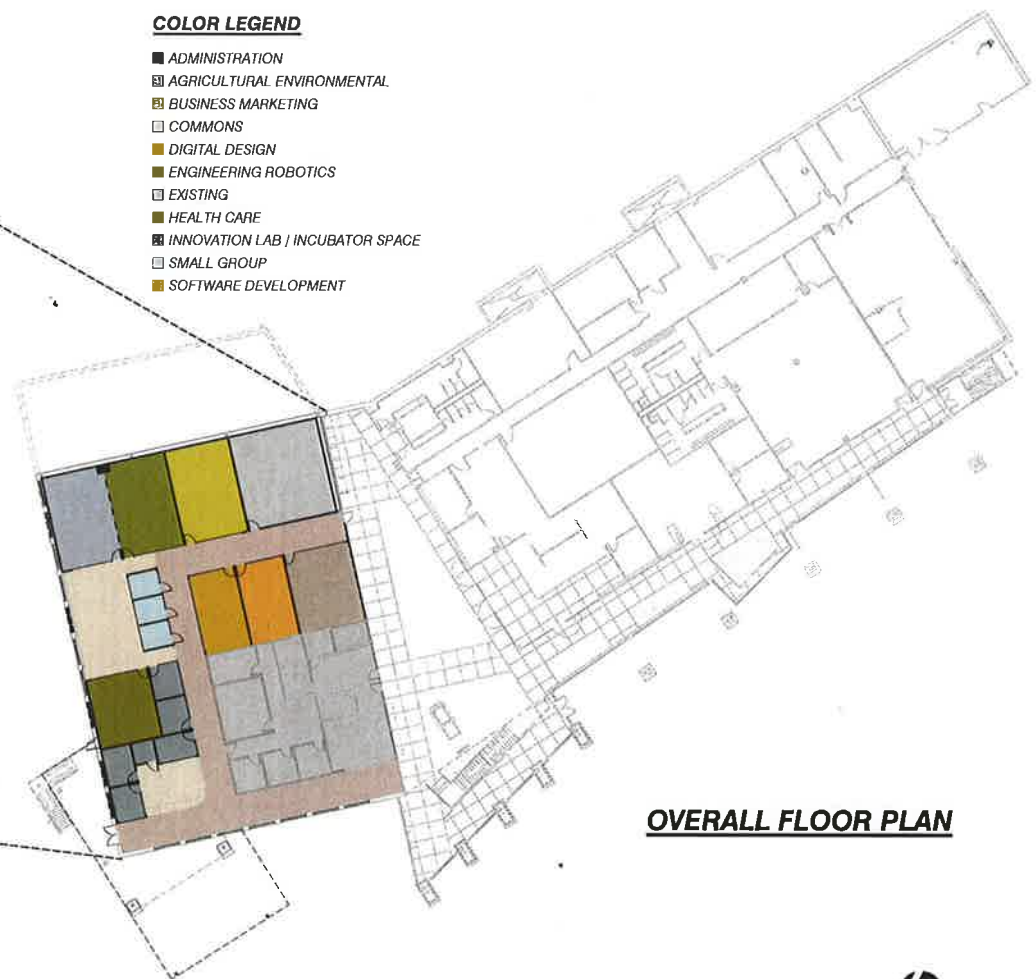

**OVERALL FLOOR PLAN**



# CENTER FOR ADVANCED PROFESSIONAL STUDIES

UTAH VALLEY UNIVERSITY - WASATCH CAMPUS

AUGUST 12, 2015

