

May 10, 2017

MEMORANDUM

TO: State Board of Regents

FROM: David L. Buhler

SUBJECT: Salt Lake Community College – Campus Master Plan Approval

Issue

As required by Regent Policy R706, *Capital Facilities Master Planning* Salt Lake Community College (SLCC) is requesting approval of its institutional campus master plan, which was last approved on May 15, 2015.

Background

Regent Policy R706 requires the Board to review and approve institutional campus master plans on a biennial basis. SLCC requests the review and approval of its updated Campus Master Plan that was last formally approved on May 15, 2015. A letter from the College and a map and master plan of College locations are attached. University officials will attend the meeting to present this agenda item and to respond to questions from the Board.

Commissioner's Recommendation

The Commissioner recommends that the Board approve the Salt Lake Community College Campus Master Plan.

David L. Buhler
Commissioner of Higher Education

DLB/KLH/RPA
Attachments



April 25, 2017

Board of Regents
c/o Commissioner David L. Buhler
Board of Regents Building, Two Gateway
60 South 400 West
Salt Lake City, UT 84101-1284

RE: Presentation of 2017 Master Plan Update

Dear Commissioner Buhler,

Salt Lake Community College looks forward to welcoming the Board of Regents to campus on May 19th. As part of the activities, SLCC will present its current Master Plan update to the Regents' Finance and Facilities Committee for approval. Included is an attachment of the locations of where SLCC has campuses and centers. Details will be explained on the day of the presentation.

Malin Francis, Director of Planning & Design for Facilities Services will present the material to the Regents' Business Committee during the May 19th meetings. Again, we look forward to your visit.

Sincerely,

A handwritten signature in black ink, appearing to read "D R Klaus", with a long horizontal line extending to the right.

Dennis R. Klaus
Vice President for Business Services & CFO

cc: Malin Francis

WESTPOINTE CAMPUS

AIRPORT CENTER

LIBRARY SQUARE AND
COMMUNITY WRITING CENTER

SOUTH CITY CAMPUS

MEADOWBROOK CAMPUS

WEST VALLEY CENTER

TAYLORSVILLE REDWOOD CAMPUS

MILLER CAMPUS

JORDAN CAMPUS

SOUTHEAST CENTER

HERRIMAN CAMPUS

COMPREHENSIVE MAP

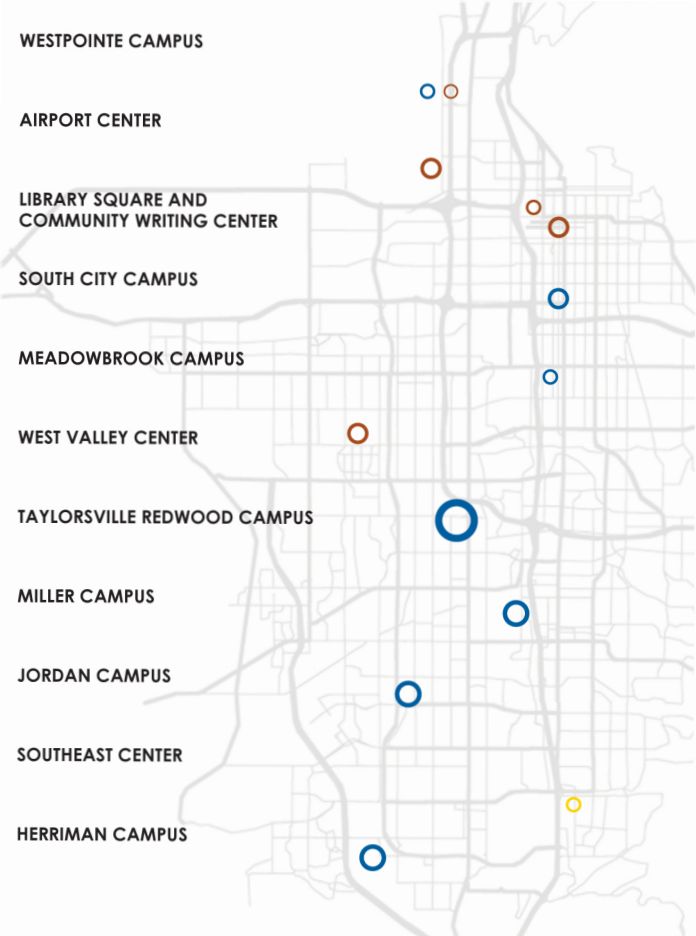

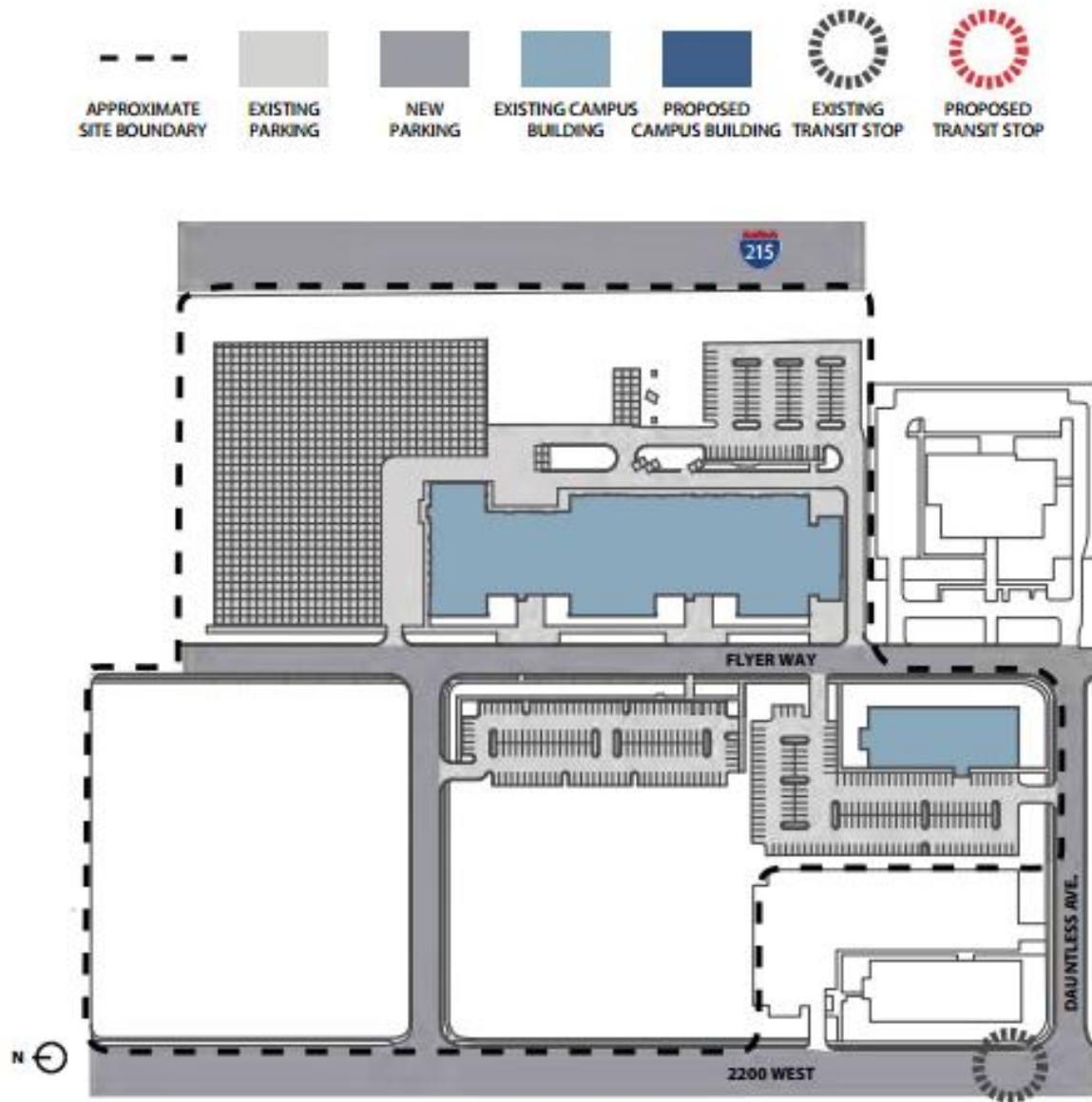

WESTPOINTE CAMPUS

The current location is at 2150 W. Dauntless Ave (1000 N.) in Salt Lake City. Westpointe Center is SLCC's northernmost campus. The College's new building is under construction at 1060 North Flyer Way.

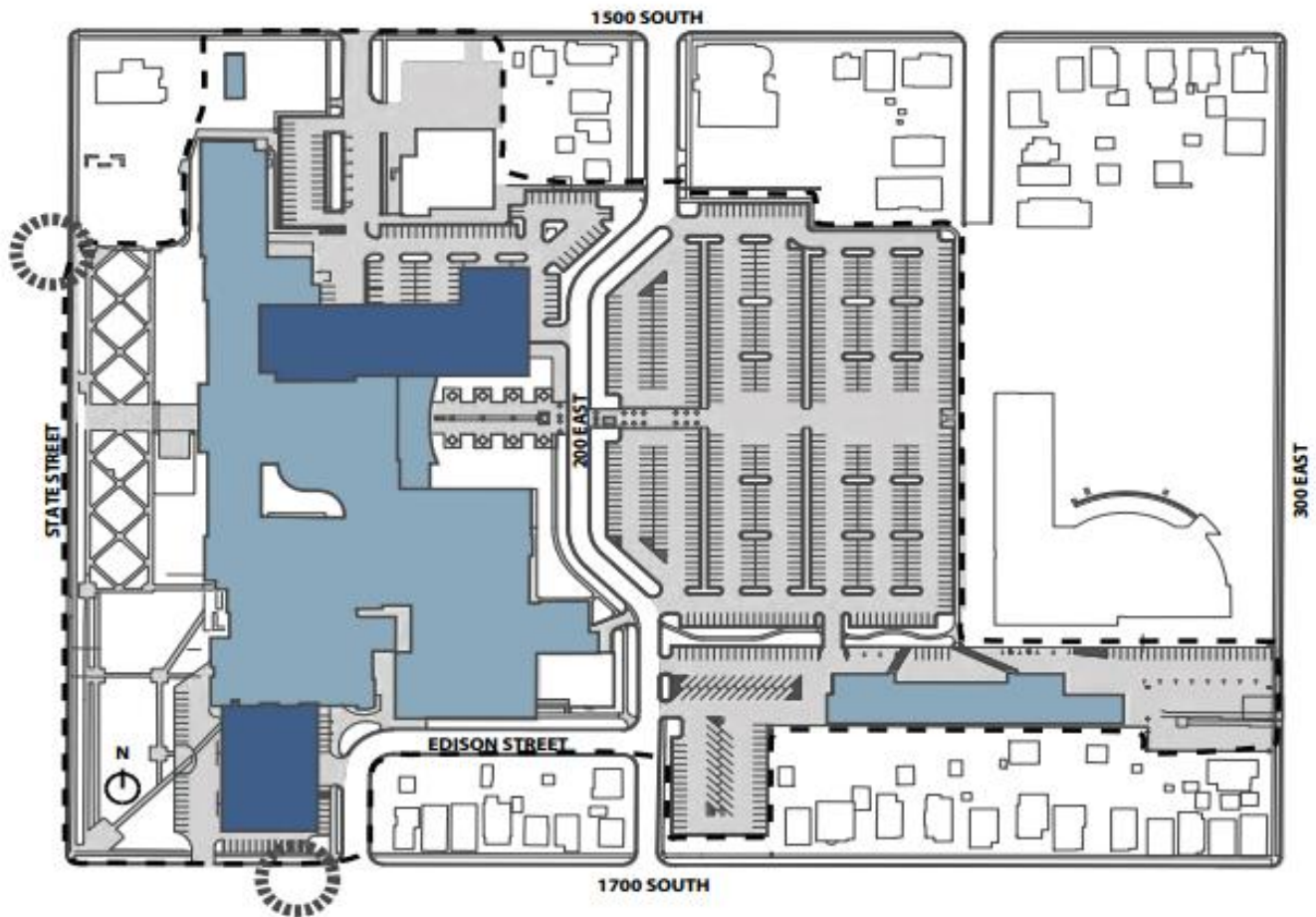

SOUTH CITY CAMPUS

Located at 1575 S. State Street, the College's South City Campus includes the remodeled South High School building and the industry-leading Center for Arts & Media (CAM).

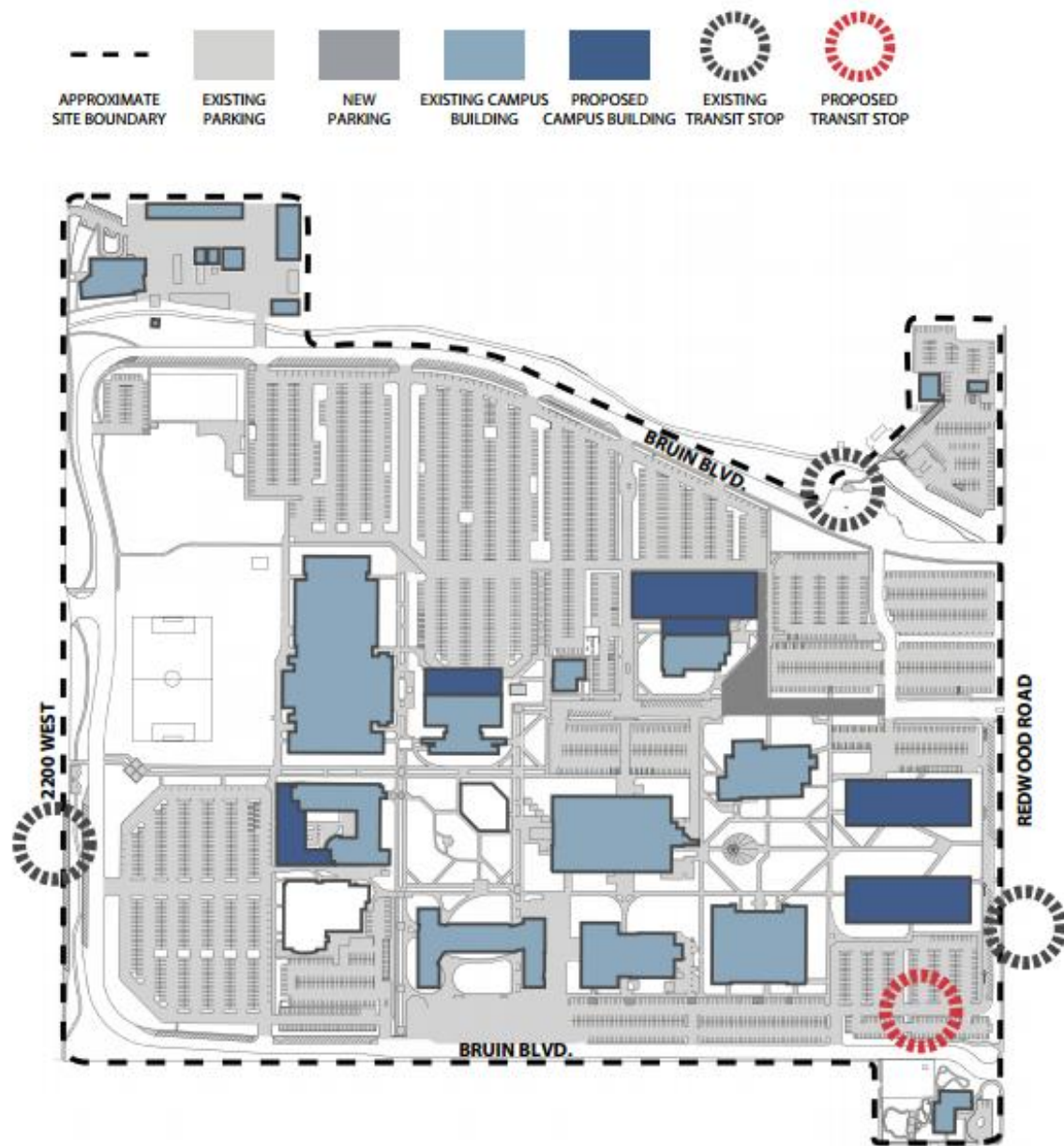

TAYLORSVILLE REDWOOD CAMPUS

Located at 4600 S. Redwood Road in Taylorsville, the Taylorsville Redwood Campus is the College's largest campus and harbors the college's main offices. Serving more than 15,000 students a year, the campus is spread across two city blocks in several academic buildings, a library, an amphitheater, a student center and athletic facilities—including the Lifetime Activities Center, Norma Carr Field for softball, and competition facilities for soccer and basketball. The College's partnership with the Utah Jazz has brought the National Basketball Association's Developmental League team—the Salt Lake City Stars—to the Taylorsville Redwood Campus where it plays home games and shares the court with the two-time national champion SLCC Bruins.

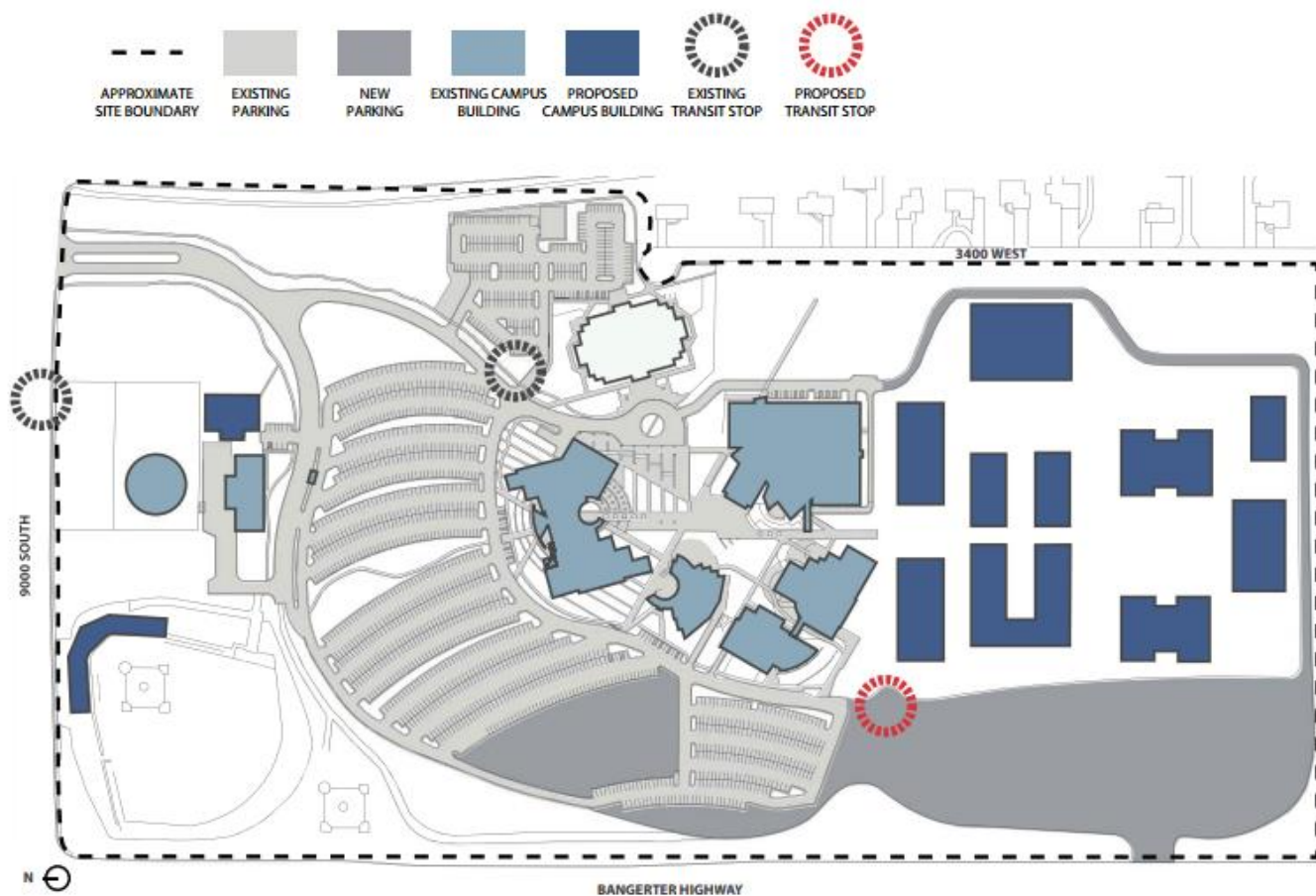

JORDAN CAMPUS

Located at 3491 W. 9000 S. in West Jordan, the Jordan Campus is the College's third full-service campus. The School of Health Sciences programs are located in the Health Sciences Center. Programs include dental hygiene, medical assistant, mortuary science, nursing, occupational therapy assistant, physical therapist assistant, radiologic technology and surgical technology.

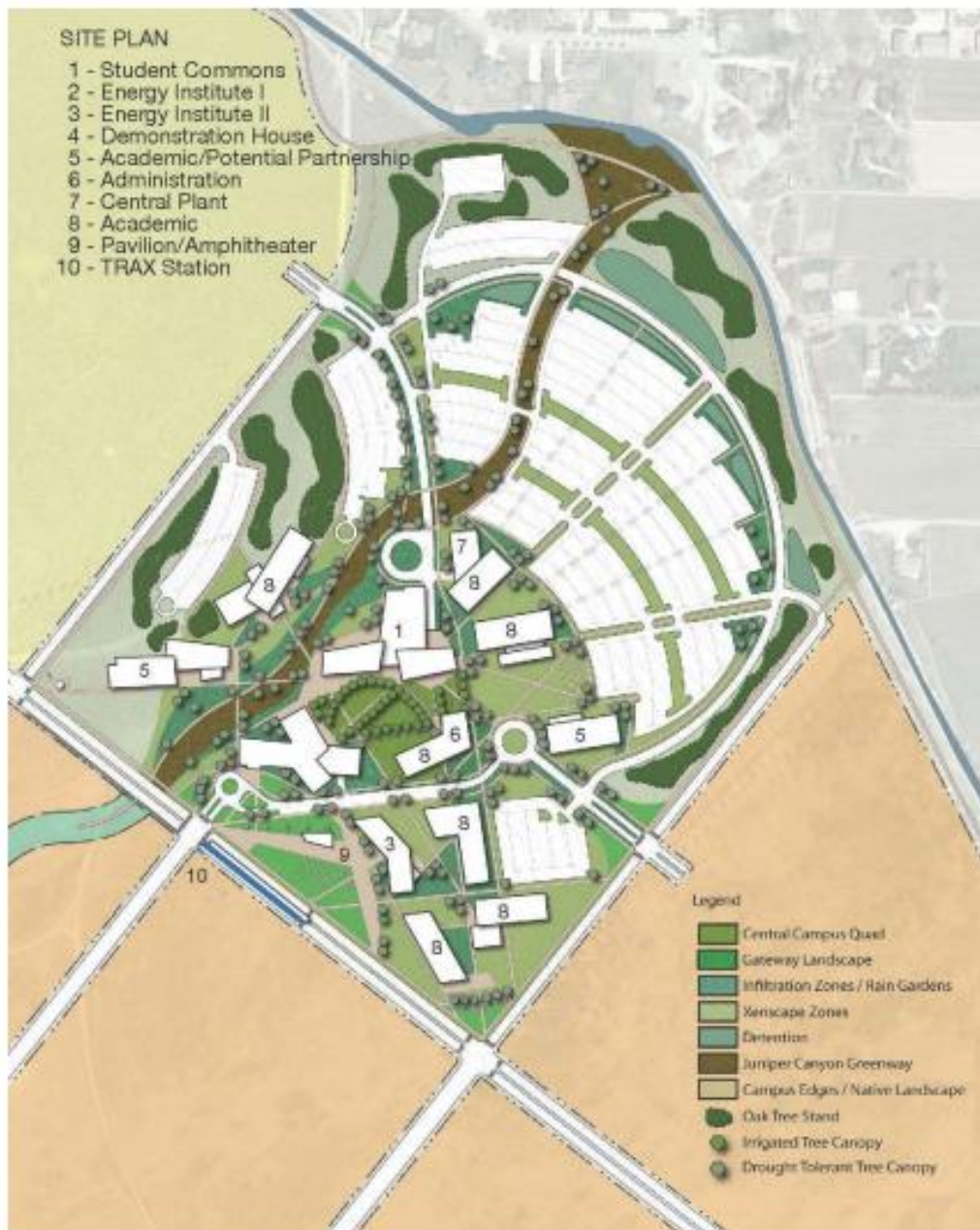

HERRIMAN CAMPUS

SLCC's Herriman Campus will be located in Salt Lake County, adjacent to the Mountain View Corridor in the rapidly expanding city of Herriman.

The primary vision for Herriman Campus is to enhance the outlook for the long-term economic viability and academic offerings for the residents of Herriman and the surrounding community, with an emphasis on sustainability and maintaining the environmental integrity of the area.

The campus will provide general education pathways to support the broader community's needs while supporting continued growth of the technology hub and commercialization opportunities along the Wasatch Front.

Herriman Campus' design will be innovative, with a goal of becoming one of North America's most sustainable community college campuses.